

SECTIONS LOCATIONS.  
SCALE 1:2000

**DRAWINGS REFERENCES:**

- REFER TO DRAWING D111-CSC-XX-XX-DR-C-0001 FOR PROPOSED ROAD LAYOUT
- REFER TO DRAWING D111-CSC-XX-XX-DR-C-0009 FOR CROSS SECTION DETAILS AND ROAD BUILD UP DETAILS.
- REFER TO DRAWING D111-CSC-XX-XX-DR-C-0013 FOR ROAD MARKINGS AND TRAFFIC SIGNS LAYOUT.

**LEGEND:**

- EXISTING GROUND LEVEL ---
- PROPOSED GROUND LEVEL ---

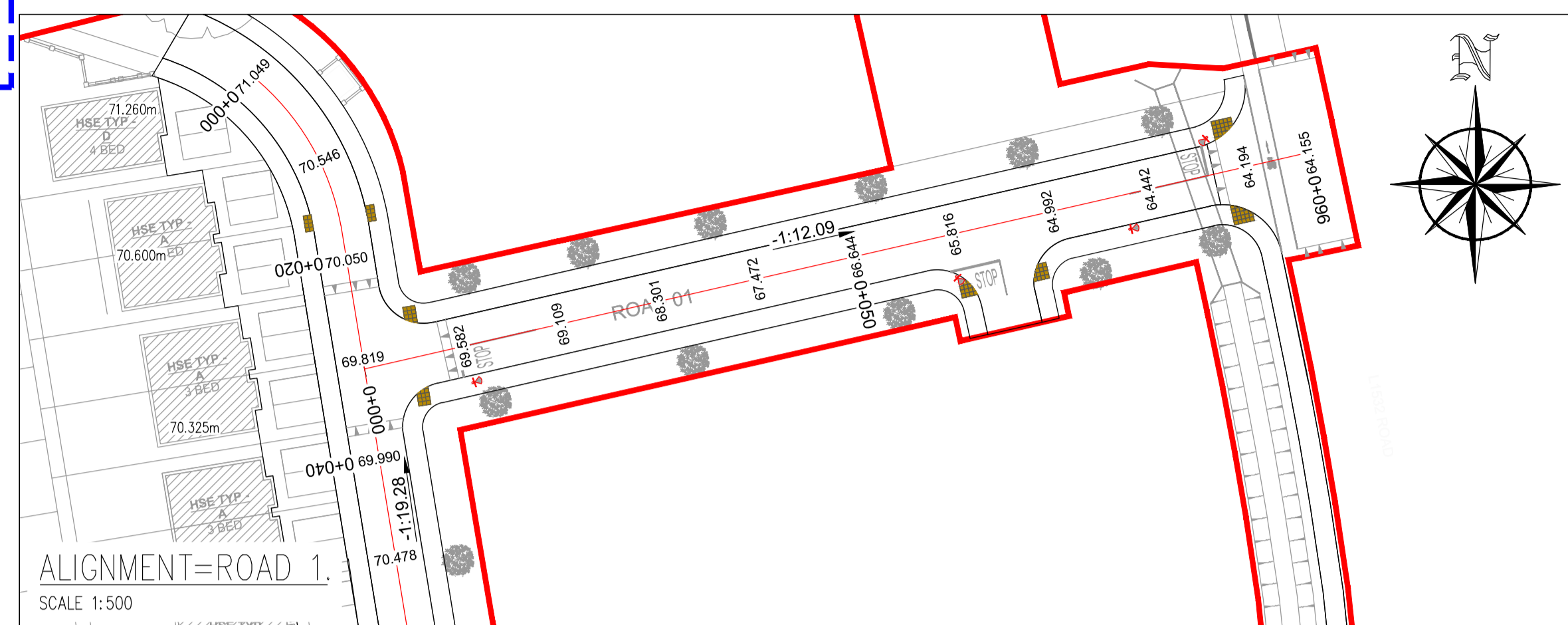

ALIGNMENT=ROAD 1.  
SCALE 1:500

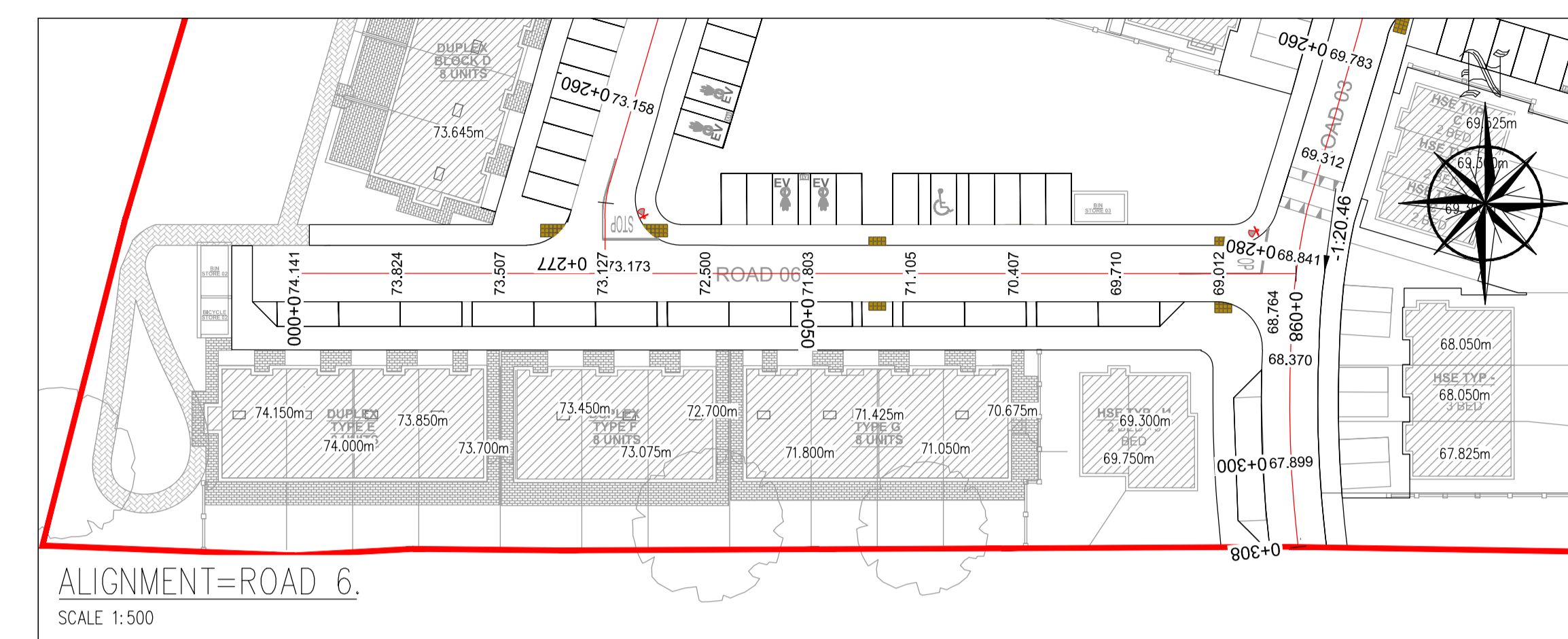

ALIGNMENT=ROAD 6.  
SCALE 1:500

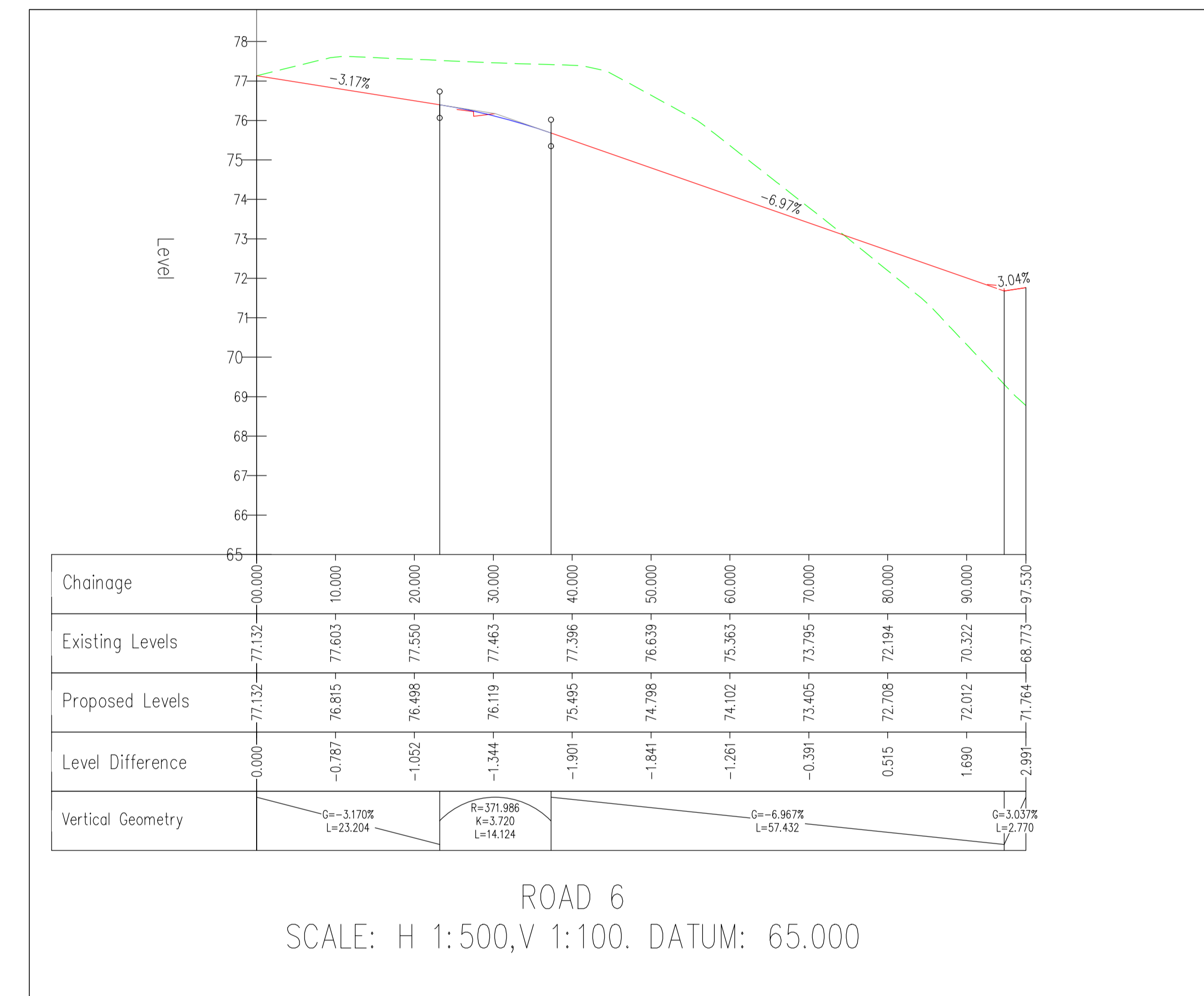
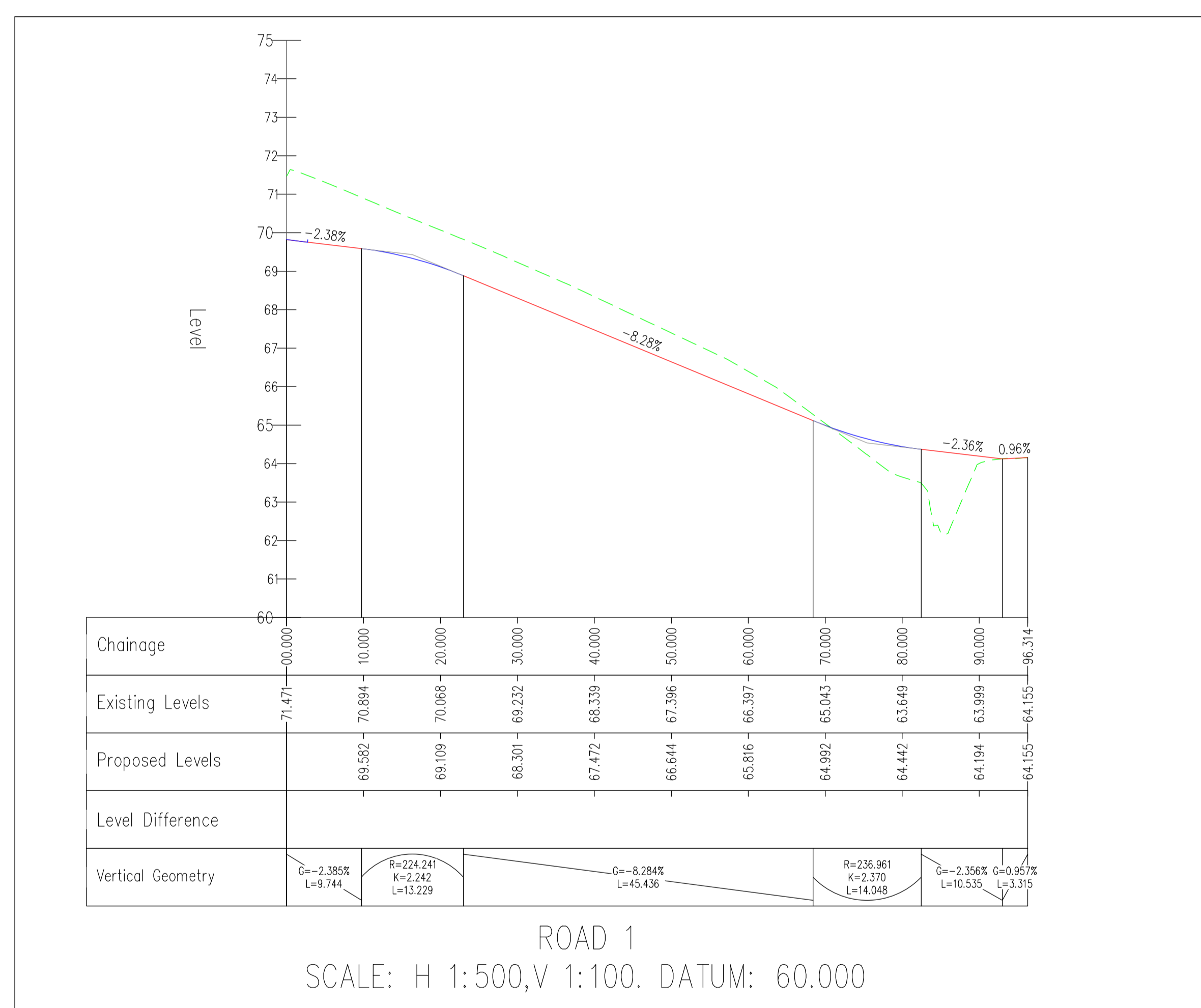

**PLANNING DRAWING.**  
NOT FOR CONSTRUCTION.  
ALL LEVELS GIVEN ARE  
RELATIVE TO ORDNANCE DATUM.  
THIS DRAWING HAS BEEN ISSUED FOR INFORMATION  
PURPOSES ONLY AND MUST NOT BE USED  
FOR CONSTRUCTION UNDER ANY CIRCUMSTANCES

- NOTES**
- For setting out refer to Architect's drawings.
  - This drawing to be read in conjunction with all other Architectural and Engineering drawings and all other relevant drawings and Specifications.
  - DO NOT SCALE THIS DRAWING. Use figured dimensions only.
  - No part of this document may be reproduced or transmitted in any form or stored in any retrieval system of any nature without the written permission as copyright holder except as agreed for use on the project for which the document was originally issued.
  - Ordnance Survey Ireland Licence Number EN 0074024

Rev. No.	Date	REVISION NOTE	Drn. By	Chkd. By
P1	17.07.2023	ISSUED FOR STAGE 2	SC	NB
P2	22.02.2024	ISSUED FOR PLANNING	SC	LJ

Architect	Michael Fitzpatrick (MFA)
Project	Drumclark Development Co. Cavan
Title	Road Plan and Profiles Sheet 1
Dwg. No.	D111-CSC-XX-XX-DR-C-0015
Date	June 2023
Drn by	SC
Chkd by	JF
Aprvd by	NB
Scale	As Shown @ A1
Revision	<b>P2</b>

**CS Consulting Group**  
DUBLIN | LONDON | LIMERICK

Head Office  
19-22 Dame Street, Dublin 2.  
T: +353 (0)1 5480863  
e: info@csconsulting.ie  
w: www.csconsulting.ie

Quality Environment Health & Safety  
NSAI Certified

IS. EN ISO 9001:2008  
IS. EN ISO 14001:2004  
IS. EN ISO 50001:2011  
OHSAS 18001:2007