

HOUSE TYPE/LEISURE	QTY.
HOUSE TYPE A (3 BED - 3 STOREY SEMI DETACHED)	10
HOUSE TYPE AS (3 BED - 3 STOREY SEMI DETACHED)	4
HOUSE TYPE B (3 BED - 3 STOREY SEMI DETACHED)	6
HOUSE TYPE B1 (3 BED - 3 STOREY SEMI DETACHED)	2
HOUSE TYPE C (3 BED - 3 STOREY TERRACE)	3
HOUSE TYPE D (4 BED - 3 STOREY DETACHED)	3
HOUSE TYPE D1 (4 BED - 3 STOREY DETACHED)	2
HOUSE TYPE E (3 BED - 3 STOREY TERRACE)	6
HOUSE TYPE E1 (3 BED - 3 STOREY TERRACE)	3
HOUSE TYPE E2 (3 BED - 3 STOREY SEMI DETACHED)	2
HOUSE TYPE F (3 BED - 3 STOREY SEMI DETACHED)	6
HOUSE TYPE G (3 BED - 3 STOREY SEMI DETACHED)	2
HOUSE TYPE H (3 BED - 3 STOREY SEMI DETACHED)	4
HOUSE TYPE I (3 BED - 3 STOREY SEMI DETACHED)	8
HOUSE TYPE J (3 BED - 3 STOREY SEMI DETACHED)	4
TERRACE BLOCK A (3 BED - 2 STOREY)	5
TERRACE BLOCK B (3 BED - 2 STOREY)	5
TERRACE BLOCK C (3 BED - 2 STOREY)	5
TERRACE BLOCK D (3 BED - 2 STOREY)	5
TERRACE BLOCK E (3 BED - 2 STOREY)	5
TERRACE BLOCK F (3 BED - 2 STOREY)	5
TERRACE BLOCK G (3 BED - 2 STOREY)	5
TERRACE BLOCK H (3 BED - 2 STOREY)	5
TERRACE BLOCK I (3 BED - 2 STOREY)	5
TERRACE BLOCK J (3 BED - 2 STOREY)	5
TERRACE BLOCK K (3 BED - 2 STOREY)	5
TERRACE BLOCK L (3 BED - 2 STOREY)	5
TERRACE BLOCK M (3 BED - 2 STOREY)	5
TERRACE BLOCK N (3 BED - 2 STOREY)	5
TERRACE BLOCK O (3 BED - 2 STOREY)	5
TERRACE BLOCK P (3 BED - 2 STOREY)	5
TERRACE BLOCK Q (3 BED - 2 STOREY)	5
TERRACE BLOCK R (3 BED - 2 STOREY)	5
TERRACE BLOCK S (3 BED - 2 STOREY)	5
TERRACE BLOCK T (3 BED - 2 STOREY)	5
TERRACE BLOCK U (3 BED - 2 STOREY)	5
TERRACE BLOCK V (3 BED - 2 STOREY)	5
TERRACE BLOCK W (3 BED - 2 STOREY)	5
TERRACE BLOCK X (3 BED - 2 STOREY)	5
TERRACE BLOCK Y (3 BED - 2 STOREY)	5
TERRACE BLOCK Z (3 BED - 2 STOREY)	5
TOTAL UNITS:	145
NO.	NO.

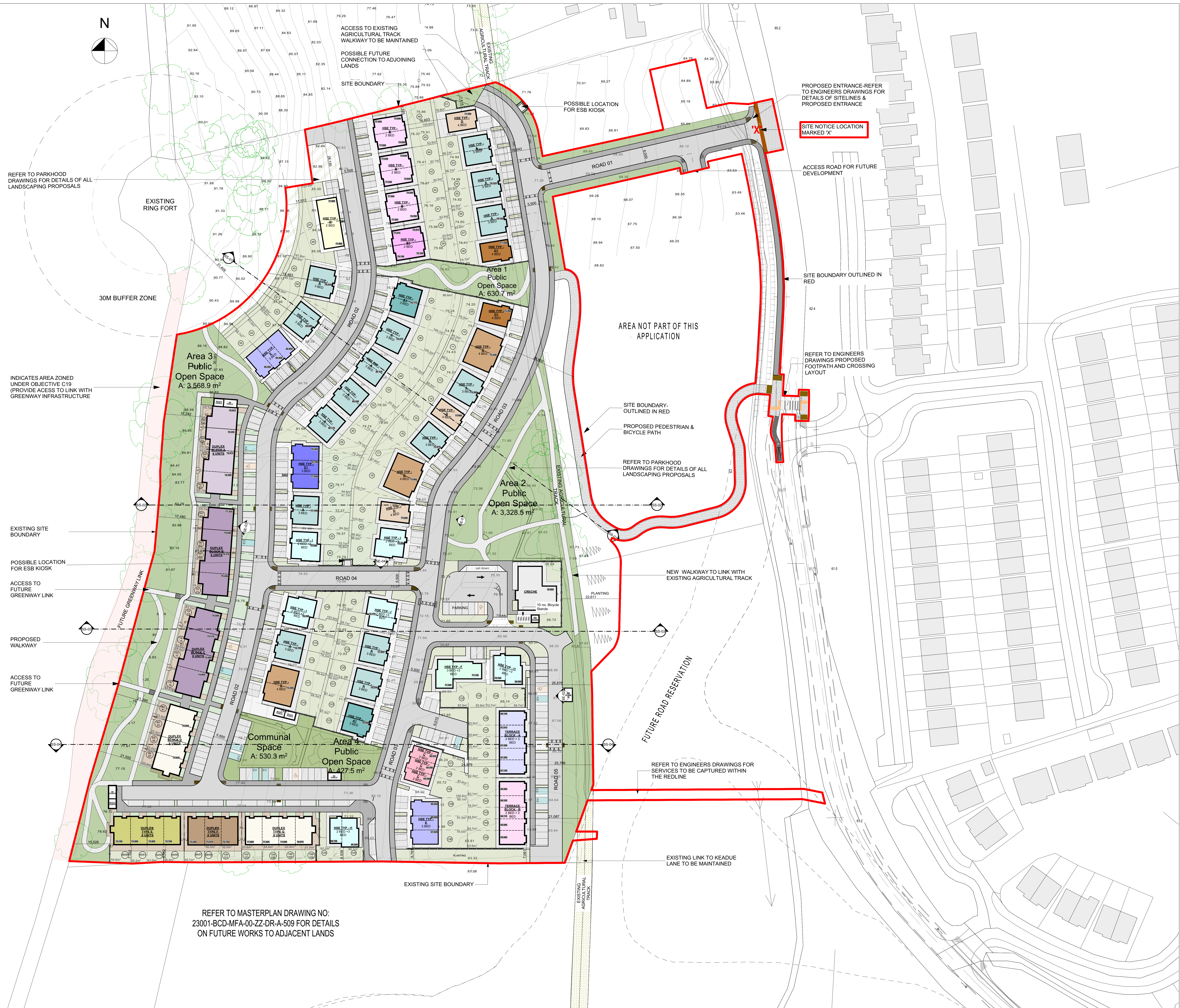

INDICATES AREA ZONED UNDER OBJECTIVE C19 (PROVIDE ACCESS TO LINK WITH GREENWAY INFRASTRUCTURE)

EXISTING SITE BOUNDARY

POSSIBLE LOCATION FOR ESB KIOSK

ACCESS TO FUTURE GREENWAY LINK

PROPOSED WALKWAY

ACCESS TO FUTURE GREENWAY LINK

PROPOSED ENTRANCE-REFER TO ENGINEERS DRAWINGS FOR DETAILS OF SITELINES & PROPOSED ENTRANCE

SITE NOTICE LOCATION MARKED 'X'

AREA NOT PART OF THIS APPLICATION

SITE BOUNDARY OUTLINED IN RED

PROPOSED PEDESTRIAN & BICYCLE PATH

REFER TO PARKHOOD DRAWINGS FOR DETAILS OF ALL LANDSCAPING PROPOSALS

NEW WALKWAY TO LINK WITH EXISTING AGRICULTURAL TRACK

FUTURE ROAD RESERVATION

REFER TO ENGINEERS DRAWINGS FOR SERVICES TO BE CAPTURED WITHIN THE REDLINE

NOTES:
 All dimensions to be taken on site.
 No dimensions to be scaled from this drawing.
 This drawing is to be read in conjunction with all other relevant drawings, Specifications ETC.
 Any Discrepancies to be reported to the Architect for clarification. This drawing may not be copied or reproduced without written consent.
 No works should be carried out without prior consent from the local planning authority.
 Please note that this is a planning drawing and is therefore limited in its capacity to convey the total information, details & specifications necessary to complete the works. Any work carried out that is not specified or detailed here will be the responsibility of the persons carrying out them out. If any situation arises which could cause a contribution of the building regulations, then the architect should be consulted. otherwise the architect can not be held responsible.
 All work and materials are to be in accordance with current building regulations whether detailed on this drawing or not.

SITE BOUNDARY

REFER TO ENGINEERS DRAWINGS FOR LEVELS AND ROAD DESIGN AND SPECIFICATION

PLANNING ONLY

PROJECT NO:	23001-BCD-MFA-00-00-DR-A-503	ISSUE FOR STAGE 4 IARD APPLICATION	MF
ISSUE DATE:		DESCRIPTION:	APPRO

Michael Fitzpatrick ARCHITECTS

PROJECT DETAILS
 Proposed development at Drumlark, Cavan, Co. Cavan for Drumlark Investments Ltd
 PLANNING DRAWINGS- SITE LAYOUT PLAN

Drawn by: S. Finnegan
 Checked by: M. Fitzpatrick
 Date: 23/03/2024
 Scale: 1:500

Co. Cavan
 www.michaelfitzpatrick.ie
 info@michaelfitzpatrick.ie
 047 4362800