

ROADS LEGEND:

- SITE BOUNDARY [Red Line]
- PROPOSED ROAD [Grey Line]
- PROPOSED FOOTPATH [Light Grey Line]
- PROPOSED SHARED SURFACE [Dotted Pattern]
- PROPOSED CYCLETRACK ON ROAD [Orange Line]
- PROPOSED CYCLETRACK OFF ROAD [Dark Grey Line]
- PROPOSED PARKING SPACE [Light Brown Pattern]
- PROPOSED EV PARKING SPACE [Dark Brown Pattern]
- PROPOSED RAISED TABLE [Dark Grey Pattern]
- PROPOSED TACTILE PAVING RED COLOURED (CONTROLLED PEDESTRIAN CROSSING) [Red Square]
- PROPOSED TACTILE PAVING BUFF COLOURED (UNCONTROLLED CROSSING) [Yellow Square]
- PROPOSED CORDUROY TACTILE PAVING [Yellow Square]

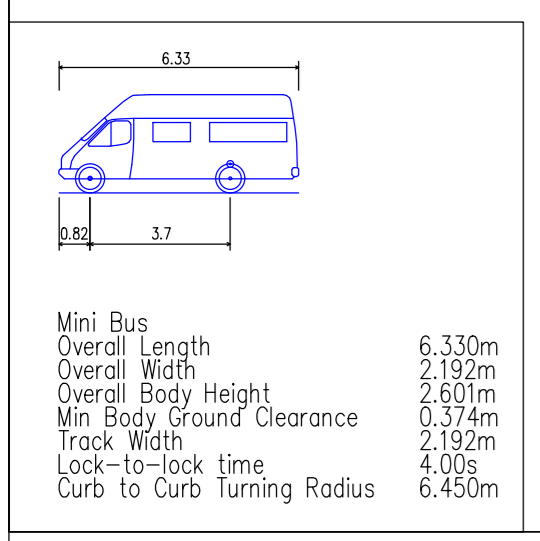
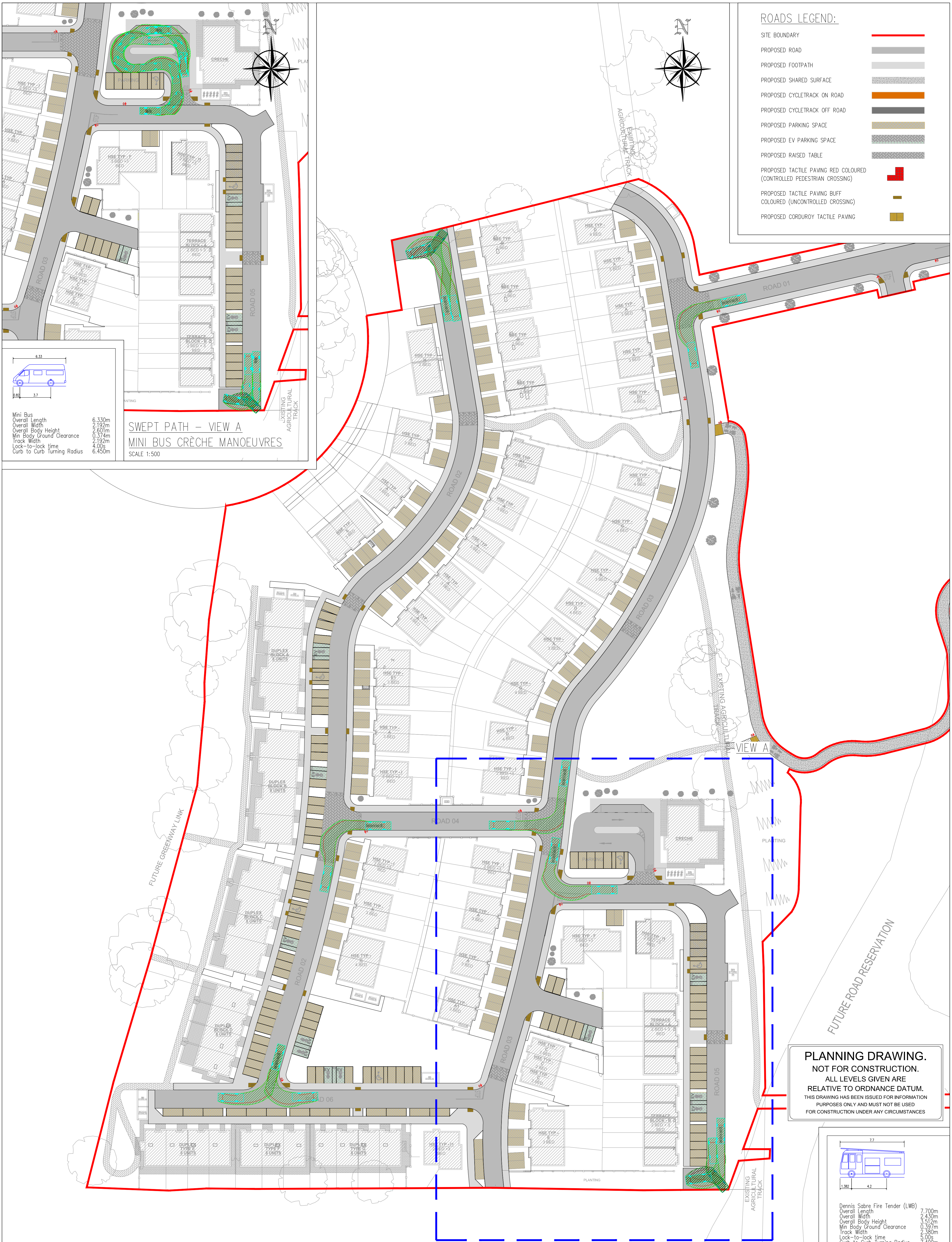
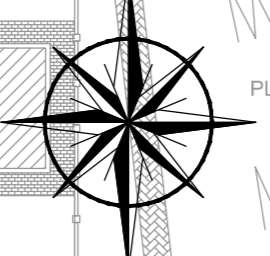

SWEPT PATH – VIEW A
MINI BUS CRÈCHE MANOEUVRES
 SCALE 1:500

FUTURE ROAD RESERVATION

FUTURE GREENWAY LINK

PLANNING DRAWING.
NOT FOR CONSTRUCTION.
 ALL LEVELS GIVEN ARE
 RELATIVE TO ORDNANCE DATUM.
 THIS DRAWING HAS BEEN ISSUED FOR INFORMATION
 PURPOSES ONLY AND MUST NOT BE USED
 FOR CONSTRUCTION UNDER ANY CIRCUMSTANCES

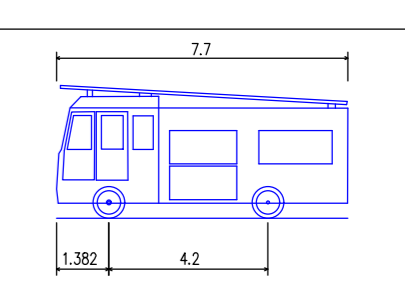

Dennis Sabre Fire Tender (LWB)
 Overall Length 7.700m
 Overall Width 2.430m
 Overall Body Height 3.512m
 Min Body Ground Clearance 0.397m
 Track Width 2.360m
 Lock-to-lock time 5.00s
 Curb to Curb Turning Radius 7.400m

D111

NOTES

- For setting out refer to Architect's drawings.
- This drawing to be read in conjunction with all other Architectural and Engineering drawings and all other relevant drawings and Specifications.
- DO NOT SCALE THIS DRAWING. Use figured dimensions only.
- No part of this document may be reproduced or transmitted in any form or stored in any retrieval system of any nature without the written permission as copyright holder except as agreed for use on the project for which the document was originally issued.
- Ordnance Survey Ireland Licence Number EN 0074024

Rev. No.	Date	REVISION NOTE	Drn. By	Chkd. By
P1	17.07.2023	ISSUED FOR STAGE 2	SC	NB
P2	22.02.2024	ISSUED FOR PLANNING	SC	LJ

Architect	Michael Fitzpatrick (MFA)
Project	Drummark Development Co. Cavan
Title	Swept Path Analysis Fire Tender and Mini Bus
Dwg. No.	D111-CSC-XX-DR-C-0011
Date	June 2023
Drn. by	SC
Chkd. by	JF
Apprv. by	NB
Scale	1:500 @ A1
Revision	P2

CS Consulting Group
 DUBLIN | LONDON | LIMERICK

Head Office
 19-22 Dame Street, Dublin 2.
 T: +353 (0)1 5480863
 e: info@csconsulting.ie
 w: www.csconsulting.ie

Quality Environment IS. EN ISO 9001:2008
 NSAI Certified Energy IS. EN ISO 14001:2004
 Health & Safety OHSAS 18001:2007